

STEP 48 Preload
STEP 98 Preload

Apply Loctite 243 to the M3 screw (1).
Attach the dead bolt indication bracket to STEP 49/98 Preload
with a torque screwdriver set 2 Nm.

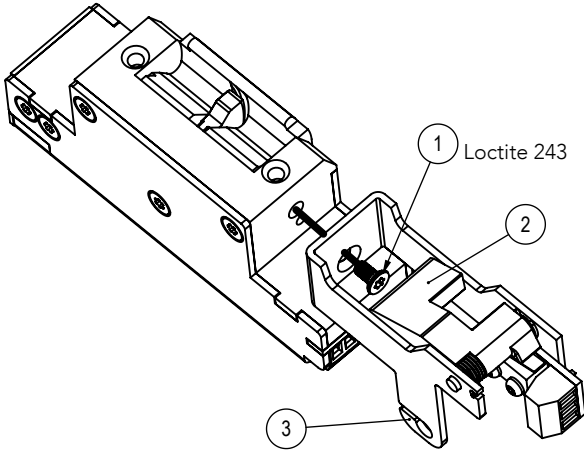

1.

2. If the dead bolt indicator is mounted on the PCB terminal block side,
cables can be led through the bracket hook (3) in order not to prevent
the indicator's (2) movement. Check that the indicator flap may move
unobstructed.

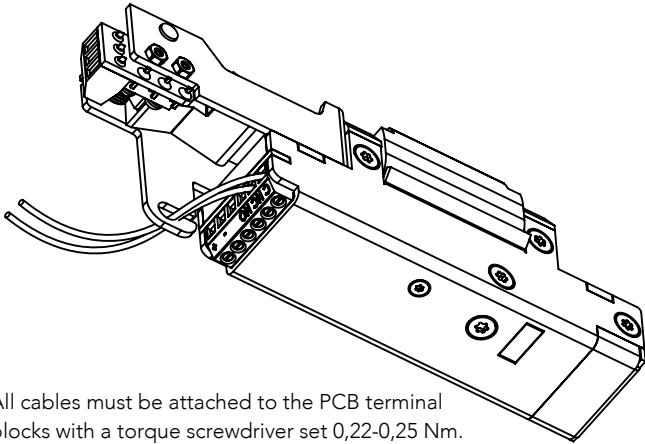

All cables must be attached to the PCB terminal
blocks with a torque screwdriver set 0,22-0,25 Nm.

3. Attach STEP 48/98 Preload to the faceplate.

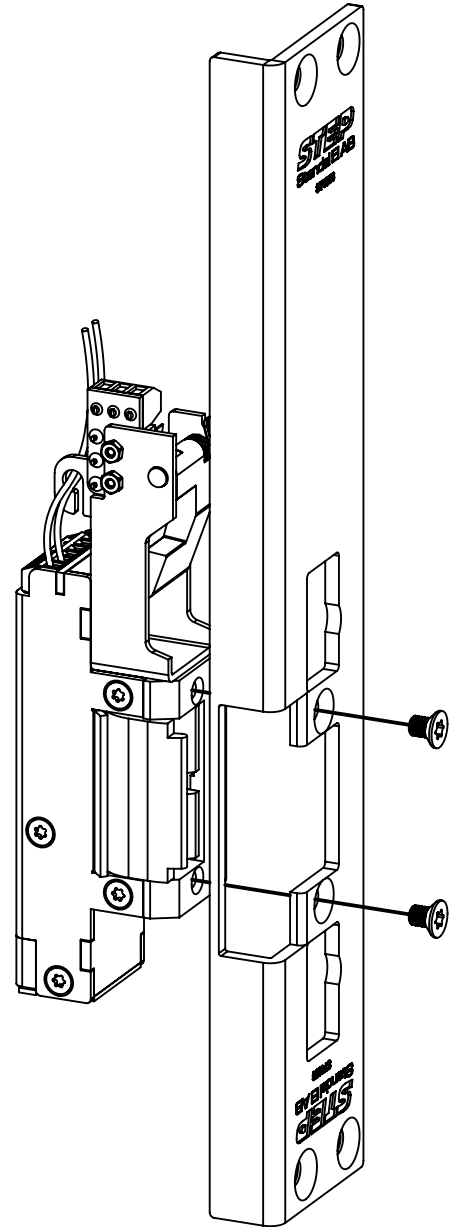

Wiring diagram

