

HPR® 250 kg preload

## STEP 90 Preload™

– Fire resistant, minimal dimensions and high quality with advanced HPR® technology

The market's smallest fire approved electric strike. Unique HPR®-technology ensures opening at 250 kg preload, which provides unmatched operational reliability. Approved in fire resistance class E/EI120.



### **Operational reliability that works in real life**

STEP 90 Preload combines minimal dimensions with very high performance for doors with normal security requirements. The electric strike is highly reliable and tested for high opening frequency.

The break resistant is 1 200 kg and the attachment can, in addition to the faceplate, be secured with angled screws at the rear edge of the electric strike.

### **Unique HPR® technology ensures opening at 250 kg preload**

High Preload Release® technology ensures that the door can unlock, despite a preload of the door of 250 kg. This exceeds the requirements of EN 13637 and is by far the technology on the market that can withstand the highest preload. In an emergency situation, this is an absolute necessity to ensure a functioning emergency evacuation.

### **Aesthetic mount and easy installation**

With its small dimensions, the electric strike fits with little adjustment into the recess for the door's standard strike plate.

### **Great flexibility with adjustable function**

Available in an adjustable configuration so that function can be easily selected and changed during installation. The electric strike can be quickly changed from fail secure to fail safe function, which provides a great flexibility and lower handling costs.

### **Wide range of faceplates**

Choose from a wide range of stainless steel faceplates. STEP 90 Preload has the same faceplate assortment as STEP 40, 48, 98 Preload.

***When it has to work.***

**STEP**  
**90**  
PRELOAD

## Technical data

Power consumption 24 V DC	Power consumption 12 V DC
0 mA with rotating cam in standby	0 mA with rotating cam in standby
110 mAh at unlocked (fail secure) / locked (fail safe)	220 mAh at unlocked (fail secure) / locked (fail safe)

Max. 300 mA at 24 V DC / 600 mA at 12 V DC for 0.2 seconds to fulfil the need for locking or unlocking upon special events. Contact us in the event of systems with balanced alarm loop.

Article number for Scandinavian standards	Designation
ST90	Fail secure function 24 V DC.
ST90-12	Fail secure function 12 V DC.
ST900	Fail secure function 24 V DC, including bolt contact.
ST900-12	Fail secure function 12 V DC, including bolt contact.
ST901	Fail safe function 24 V DC, including bolt contact.
ST901-12	Fail safe function 12 V DC, including bolt contact.
ST905	Adjustable function 24 V DC, including bolt contact.
ST905-12	Adjustable function 12 V DC, including bolt contact.
ST91	Fail safe function 24 V DC.
ST91-12	Fail safe function 12 V DC.
ST95	Adjustable function 24 V DC.
ST95-12	Adjustable function 12 V DC.

					
Preload: 250 kg	Anti-hammer secured	Break resistance: 1 200 kg	Factory tested: 1 500 000 cycles	Fire resistance class: E/EI 120	

### Product characteristics

- Durability: Grade X per EN 14846.
- Corrosion: Grade M per EN 14846.
- Security: Grade 3 per EN 14846.
- Security electrical manipulation: Grade 1 per EN 14846.
- Approved fire resistance class E/EI 120.
- Microswitch unipolar changeover, max. 30 V DC, 1A.
- Built-in protective diode.
- Detection indication door open/closed (products with bolt contact).
- Break resistance 1 200 kg (≈ 12 kN).
- Equipped with patented HPR® technology.
- The HPR® technology ensures opening despite 250 kg (≈ 2,5 kN) preload in fail secure/fail safe function.
- Anti-hammer secured.
- Reversible to fit right- and left hung doors.
- Screw holes for angled screws at rear edge of electric strike.
- Suitable lock cases for the Scandinavian market: single and double latch locks in the Connect, Modul and Narrow profile systems.

## HPR® 250 kg preload

A common problem is that a door is subjected to pressure, for example, because the door is a little skew or that gravel or snow has gathered at the doorstep. STEP 90 Preload is equipped with STEP's unique HPR® technology that allows the door to be unlocked even if subjected to pressures of up to 250 kg.

- **Seals and pressure differences** – The HPR® enables the door to always be unlocked even when the door lock is tensioned against the electric strike.
- **Door automation** – HPR® combined with rapid unlocking means that the door opens quickly and without risk of becoming stuck.
- **Evacuation door** – HPR® ensures that a fire alarm can release the lock, despite pressure against the door by crowds, seals, pressure differences or warped doors.

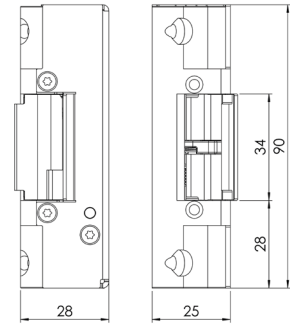

Dimensional drawing STEP 90 Preload.

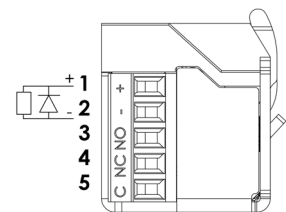

Wiring diagram without bolt indication. Connections are made with screw terminal blocks.

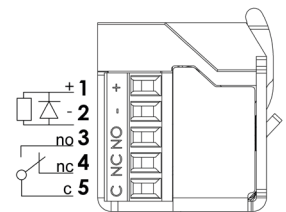

Wiring diagram with bolt indication. Connections are made with screw terminal blocks.