



STEP 21™ and STEP 22™

– Automatic flush bolts with Preload technology

STEP 21 and 22 are two automatic flush bolts for double doors where two door leaves are closed against each other. They are equipped with STEP's unique Preload technology that allows the door to open even if subjected to high pressure.

Automatic flush bolts are used on double doors that automatically lock when the two door leaves are closed against each other. The door leaf that closes first is called the passive door and the other is called the active door leaf.

Function

The automatic flush bolts are usually mounted on the upper and lower part of the passive door leaf, where you want the passive door leaf to lock automatically when the active door leaf is closed. The active door leaf is then automatically locked with a regular lock on the passive door leaf.

In the same way, automatic flush bolts are designed to automatically unlock the passive door leaf each time the active door leaf is opened.

For wooden, steel and aluminium doors

STEP 21 is designed for wooden or steel doors, STEP 22 is designed for aluminium doors.

When it has to work.



STEP
21

STEP
22

Technical data

Art.no	Designation
STEP 21	Designed for wooden or steel doors.
STEP 21DH*	Designed for Daloc doors, right hung doors.
STEP 21DV	Designed for Daloc doors, left hung doors.
STEP 21R-H	Designed for Robust steel doors, right hung doors.
STEP 21R-V	Designed for Robust steel doors, left hung doors.
STEP 22	Designed for aluminium doors.
Art.no accessories	Designation
ST953-1	Strike plate for STEP 21 and STEP 22.
ST953-2	Sliding plate for STEP 21 and STEP 22.

* Cannot handle preload

- Steel material for fire doors.
- Deadbolt 16 mm.
- The deadbolt's throw is 16 mm.
- The deadbolt is adjustable + 25 mm.
- Guarantees opening despite preload.

STEP's unique Preload technology

A common problem is that a door is subjected to pressure, for example, because the door is a little skew or that gravel or snow has gathered at the doorstep. STEP 21 and 22 Secure are equipped with STEP's unique Preload technology that allows the door to unlock even if subjected to pressure.

- **Seals and pressure differences** – The Preload function enables the door to always be unlocked.
- **Door automation** – The Preload function combined with rapid unlocking means that the door opens quickly and without risk of becoming stuck.
- **Evacuation door** – The Preload function ensures that the passive door leaf can open, despite pressure against the door by crowds, seals, pressure differences or warped doors.

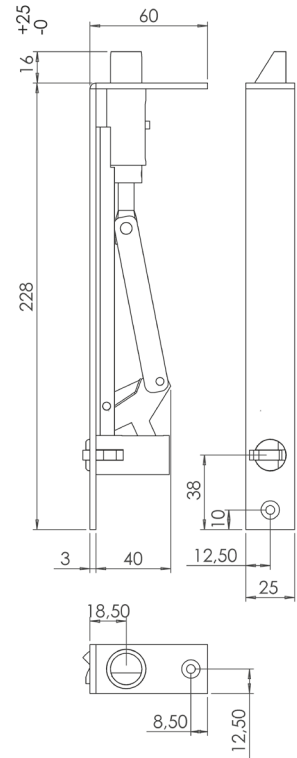

Dimensional drawing STEP 21.

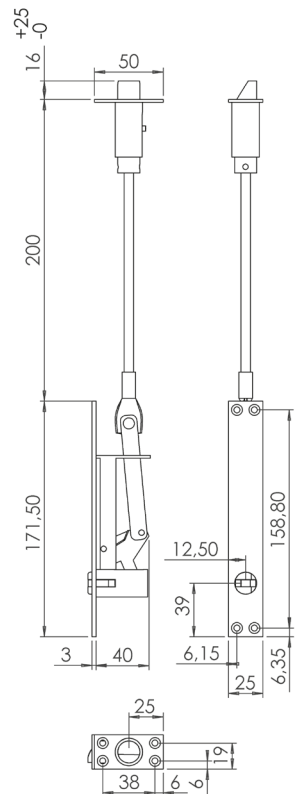

Dimensional drawing STEP 22.